

Flat pot magnets of Samarium-Cobalt (SmCo)

Flat pot magnets of SmCo, stainless steel body, with cylinderbore, until 350°C

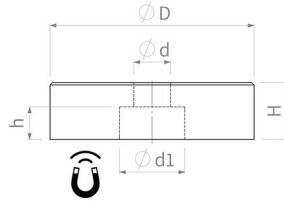

Article number	D mm	d mm	d1 mm	H mm	h mm	Adhesive force* N	Weight g	Temperature °C
F16-SCCVAHT	16 ^{+0.1} / _{-0.1}	3,5 ^{+0.1} / _{-0.1}	6 ^{+0.1} / _{-0.1}	4,5 ^{+0.1} / _{-0.1}	3	41	5.8	350
F20-SCCVAHT	20 ^{+0.1} / _{-0.1}	4,5 ^{+0.1} / _{-0.1}	8 ^{+0.1} / _{-0.1}	6 ^{+0.1} / _{-0.1}	3,5	60	13	350
F25-SCCVAHT	25 ^{+0.1} / _{-0.1}	4,5 ^{+0.1} / _{-0.1}	8 ^{+0.1} / _{-0.1}	7 ^{+0.2} / _{-0.2}	4	80	24	350
F32-SCCVAHT	32 ^{+0.1} / _{-0.1}	5,5 ^{+0.1} / _{-0.1}	11 ^{+0.1} / _{-0.1}	7 ^{+0.2} / _{-0.2}	4	200	39	350
F40-SCCVAHT	40 ^{+0.1} / _{-0.1}	5,5 ^{+0.1} / _{-0.1}	10,5 ^{+0.1} / _{-0.1}	8 ^{+0.2} / _{-0.2}	4	420	75	350

* The forces have been determined at room temperature on a polished plate made of steel (S235JR according to DIN 10 025) with a thickness of 10 mm (1kg~10N). A deviation of up to -10% from the specified value is possible in exceptional cases. In general, the value is exceeded. The type of application (installation situation, temperatures, counter anchors, etc.) sometimes influence the forces enormously. The values given are for orientation purposes. Let our experts advise you.